



Quick Guide

Ver. 1.3
Release date: VII 2025
Soft: V2.117.893



Producer:
Engo Controls sp. z o.o. sp. k.
Rolna 4 St.
43-262 Kobilice
Poland

www.engocontrols.com

Introduction

The camera works with the Engo Smart app and the TUYA cloud. The camera offers excellent image quality in 4MP (2560x1440) FHD resolution. The device detects motion and human silhouettes, and the motion tracking function allows it to automatically follow moving objects within a 355° field of view. It features two-way audio communication with noise reduction. Simple installation in any lamp with an E27 thread make the camera fit perfectly into any interior.

Safety information

Use in accordance with national and EU regulations. Use the device only as intended, keeping it in a dry condition. The product is for indoor use only. Please read the entire manual, before installation or use.

Camera description



1. E27 thread
2. LED diode
3. Camera lens
4. Microphone
5. IR illumination
6. Loudspeaker
7. Micro SD slot
8. Reset button

1. Screw the camera into the holder by rotating only the stationary part of the unit to avoid damaging the head.

Inserting a memory card

Slide the black part of the camera in the direction indicated by the arrow. Slide the card into the micro SD card slot until you hear a click.

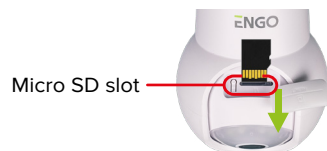

WARNING:

Micro SD (Max 256GB)- card not included
Minimum requirements of a microSDXC card
-full HD speed class - C10/U1/V10

Product Compliance

This product complies with the following EU Directives: 2014/53/EU, 2011/65/EU.

Technical specification

Power supply	110-240V AC (E27 bulb socket)
Communication	Wi-Fi 2.4GHz
Resolution	4Mpx 2560*1440P
Local storage	Micro SD (Max 256GB)- card not included Minimum requirements of a microSDXC card -full HD speed class - C10/U1/V10
Dimmension [mm]	Φ82 x 169

Installing and register the new account in the ENGO Smart app

1. Download the ENGO Smart app from Google Play or Apple App Store and install it on your smartphone.
2. Run the application.. Click „Sign Up” to create new account.
3. Enter your e-mail address to which the verification code will be sent.
4. Enter the verification code received in the email. Remember that you only have 60 seconds to enter the code!
5. Then set the login password.

Connection camera to Wi-Fi via Bluetooth

After installing the app and creating an account:

1. On your mobile device, make sure the ENGO Smart has access to permissions (Location, Bluetooth, Nearby devices). Then turn on Bluetooth and Location. Connect to 2.4GHz Wi-Fi network to which you want to assign the device.
2. Make sure the camera is powered on. Then press and hold the button on the back of the camera for approximately 5 seconds, until the beep. The blue LED on the front of the unit will then start flashing. The pairing mode is enabled.
3. In the app, select: „Add Device”.
4. After finding the camera, go „Add”
5. Select the Wi-Fi network in which the camera will operate and enter the password of this network.
6. Wait for the app to configure the device with the selected Wi-Fi network.
7. Go „Done”.
8. The camera has been installed and displays the main interface.

Connection camera to Wi-Fi via QR code

After installing the app and creating an account:



On your mobile device, make sure the ENGO Smart has access to permissions (Location, Bluetooth, Nearby devices). Then turn on Bluetooth and Location. Connect to 2.4GHz Wi-Fi network to which you want to assign the device.



Make sure the camera is powered on. Then press and hold the button on the back of the camera for approximately 5 seconds, until the beep. The blue LED on the front of the unit will then start flashing. The pairing mode is enabled.

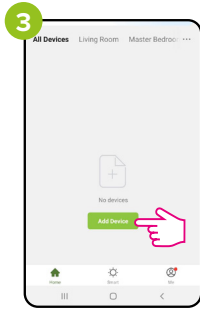

In the app, select: „Add Device”.

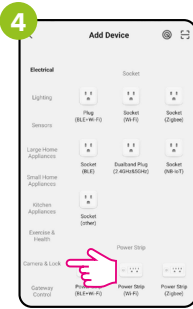

Select „Camera & Lock”.

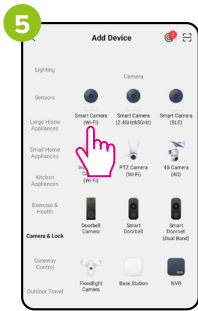

Find and click on the Wi-Fi camera in the device list.

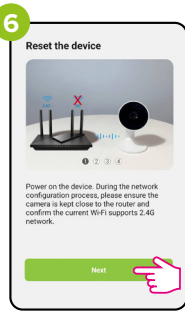

Follow the instructions displayed on the smartphone screen.

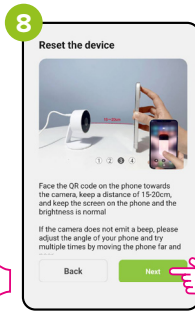
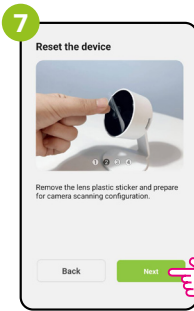

Then go „Next”.

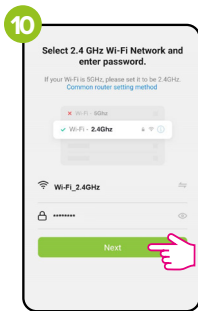

Select the Wi-Fi network in which the camera will operate and enter the password of this network.

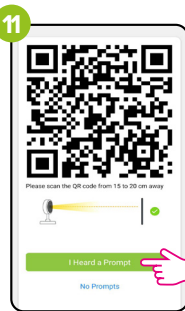

Point the camera at the QR code displayed in the app, click „I Heard a Prompt” after the beep.

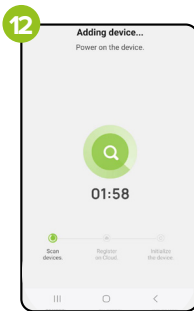

Wait for the app to configure the device with the selected Wi-Fi network.

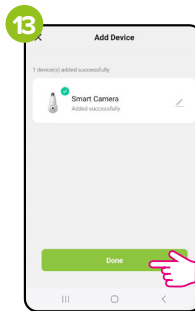

Go „Done”.

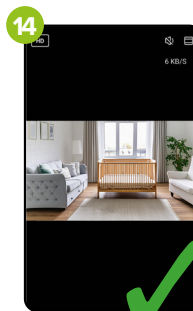

The camera has been installed and displays the main interface.

Description of camera settings and operation in the app

••• Edit additional functions, such as changing the name of the camera (upper right corner of the screen)

HD / SD Changing the resolution

🔊 Playback of audio from the camera (the camera has a built-in microphone)

📄 Screen magnification (vertical orientation)

📄 Screen magnification (horizontal orientation)

📷 Screenshot (image saves to phone gallery)

🗣️ Microphone (hold down to talk through the speaker on the camera)

📹 Screen recording (video saves to phone gallery)

☰ Additional features and settings

🔔 Messages preview (e.g., motion detected)

🔄 Direction - vertical, horizontal camera rotation and zooming

☁️ Cloud recording (extra charge option)

⚙️ **Settings:**

🎬 **Playback** of recordings (function available only when the camera is equipped with a memory card - no card included)

🖼️ **Gallery** of recordings and screenshots (saved in the phone's gallery)

🎨 **Theme color** (light or dark mode)

🔒 **Private mode** (disable transmission and audio/video recording)

📺 **HDR** - improving image quality in rooms with large differences in lighting

🌙 **Night mode:**
 - Auto - automatic switching to night mode (IR) after darkness
 - Off - permanent day mode (color), after dark possible worse image quality
 - On - permanent night mode (black and white with IR)

⚡ **Diffusion filter** (reduction of sharp contrasts in camera images)

📍 **Motion tracking** (the camera follows a moving person)

🚶 **Motion detection** (when motion is detected, sending notifications, siren can be activated)

🗣️ **Sound detection** (when sound is detected, sending notifications, siren can be activated)

📡 **Siren** (alarm signal that can be activated manually or as a result of motion or sound detection)

💡 **Light** (lighting control, you can turn the lamp on and off manually and set the lighting schedule)

🔗 **Manage** (in the area of additional functions it is possible to add shortcuts of other devices from the ENGO Smart application - for example, a light switch).

Factory reset

To restore the default settings of the camera, hold down the Reset button for about 5 seconds until a beep sounds. Then release the button. The camera will restart, restore the default (factory) values and be ready to be added to the application again.

